

Pull release operators

Non-illuminated and illuminated

30mm, 40mm & 60mm head

How to order non-illuminated:

- Alt.1** • Operator
+ Holder
+ Contact block(s)
- Alt.2** • Operator
+ Holder with Contact block(s)

How to order illuminated:

- Alt.1** • Operator
+ Holder
+ Contact block(s)
+ LED/lamp block
- Alt.2** • Operator
+ Holder with Contact block(s)
and LED/lamp block

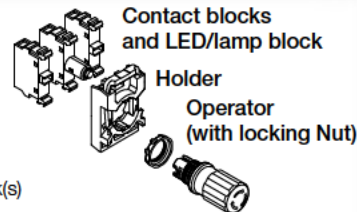

NOTE: No contact block in center position, reserved for LED/lamp block.
For contact blocks, holders & LED lamp blocks, see Accessories pages 7.54 - 7.58.

Fulfills IEC 60947-5-5

Operator: Twist or pull release operators

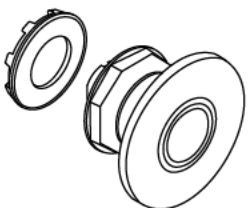
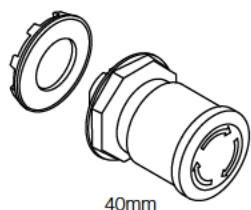

	Description	Catalog number
Non-illuminated		
30mm		
Black Plastic Bezel		
Red	Pull release	G1MPEP3-10R
Chrome bezel		
Red	Pull release	G2MEP3-10R
40mm		
Black Plastic Bezel		
Red	Pull release	G1MPEP4-10R
Chrome Bezel		
Red	Twist release	G2MPET4-10R
Illuminated		
40mm		
Black Plastic Bezel		
Red	Pull release	G1MPMP3-11R
Chrome bezel		
Red	Pull release	G2MPMP3-11R
60mm		
Black Plastic Bezel		
Red	Pull release	G1MPMP4-11R
Chrome Bezel		
Red	Twist release	G2MPMP4-11R